

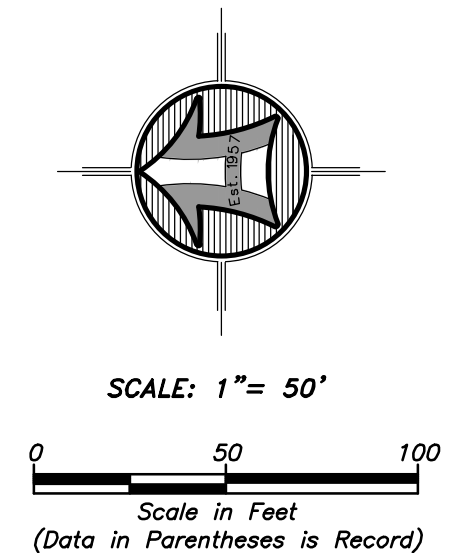

LEGEND

- SUBJECT PROPERTY LINE
- - - ADJOINING PROPERTY LINE
- - - PREVIOUS PROPERTY LINE
- - - DITCH FLOWLINE
- - - FENCE LINE
- FOUND REBAR SET BY OTHERS
- SET 5/8"x24" REBAR WITH CAP
- SECTION CORNER



NARRATIVE

THE PURPOSE OF THIS SURVEY WAS TO COMBINE PARCELS TAX ID. NO. 08-042-0085 AND 0089 INTO ONE PARCEL AS SHOWN AND DESCRIBED HEREON. THE SURVEY WAS ORDERED BY LYNNETTE GILBERT. THE CONTROL USED TO ESTABLISH THE PROPERTY CORNERS WAS THE EXISTING WEBER COUNTY SURVEY MONUMENTATION SURROUNDING SECTION 6, T5N, R2W, SLB&M.

THE BASIS OF BEARING IS THE SOUTH LINE OF THE SOUTHWEST QUARTER OF SAID SECTION 6 WHICH BEARS SOUTH 89°31'22" EAST, UTAH NORTH, STATE PLANE, CALCULATED N.A.D.83 BEARING.

PARCEL NO. 1

A PART OF THE SOUTHWEST QUARTER OF SECTION 6, TOWNSHIP 5 NORTH, RANGE 2 WEST OF THE SALT LAKE BASE AND MERIDIAN.

BEGINNING AT AN EXISTING ENSIGN REBAR AND CAP BEING IN AN EXISTING FENCE LINE AND ALSO BEING A POINT ON THE NORTH RIGHT-OF-WAY LINE OF 4000 SOUTH STREET LOCATED 659.80 FEET SOUTH 89°31'22" EAST ALONG THE SOUTH LINE OF SAID SOUTHWEST QUARTER AND 20.00 FEET NORTH 00°20'51" EAST FROM THE SOUTHWEST CORNER OF SAID SECTION 6;

RUNNING THENCE NORTH 00°20'51" EAST (NORTH 00°28'38" EAST BY RECORD) 1066.42 FEET ALONG SAID EXISTING FENCE LINE TO A THE NORTHEAST CORNER OF KD'S PLACE SUBDIVISION, RECORDED AS ENTRY NO. 1994037 IN THE WEBER COUNTY RECORDER'S OFFICE, BEING A POINT ON THE SOUTH RIGHT-OF-WAY LINE OF 3800 SOUTH STREET; THENCE NORTH 90°00'00" EAST 391.69 FEET ALONG SAID SOUTH RIGHT-OF-WAY LINE; THENCE SOUTH 00°21'47" WEST (SOUTH 00°28'38" WEST BY RECORD) 1069.68 FEET TO TWO EXISTING 5/8" REBARS, SIDE BY SIDE BEING ON THE NORTH RIGHT-OF-WAY LINE OF SAID 4000 SOUTH STREET; THENCE NORTH 89°31'22" WEST 391.39 FEET ALONG SAID SOUTH RIGHT-OF-WAY LINE TO THE POINT OF BEGINNING. CONTAINING 9.60 ACRES.

SURVEYOR'S CERTIFICATE

I, K. Greg Hansen, do hereby certify that I am a Registered Professional Land Surveyor in the State of Utah in accordance with Title 58, Chapter 22, Professional Engineers and Professional Land Surveyors Act; and by the authority of the owners, I have completed a survey of the property described and shown hereon this plat in accordance with Section 17-73-504 and have verified all measurements, and that the same has been surveyed and monuments have been located and/or placed on the ground as represented on the plat hereon.

Signed this 2nd day of April, 2026.

K. Greg Hansen PLS
Utah Land Surveyor License No. 167819

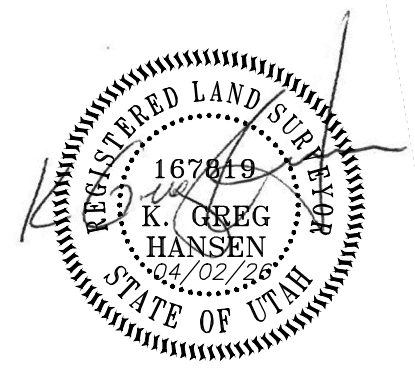

RECEIVED
MAY 18 2026
FILE # 8369

HANSEN & ASSOCIATES, INC. Consulting Engineers and Land Surveyors 538 North Main Street, Brigham, Utah 84302 Visit us at www.hales.net Logan Ogden (435) 723-4491 (801) 399-4905 (435) 732-8272 Celebrating over 60 Years of Business	
HAI	No. _____ Date _____ By _____ Revision _____
Drawn By: TM Designed By: _____ Checked By: _____ Approved By: _____ Scale: 1" = 50' Drawing File: 26-3-76x23.dwg JOB NUMBER: 26-3-76	Date: 04/02/2026
LYNNETTE GILBERT 5794 WEST 4000 SOUTH HOOPER, WEBER COUNTY, UTAH A PART OF THE SOUTHWEST QUARTER OF SECTION 6, TOWNSHIP 5 NORTH, RANGE 2 WEST, S.L.B.&M.	
Sheet 1 of 1 Sheets	