

**OVERALL BOUNDARY DESCRIPTION**

A PART OF THE SOUTHEAST QUARTER OF SECTION 18, TOWNSHIP 6 NORTH, RANGE 1 EAST, OF THE SALT LAKE BASE AND MERIDIAN, BEGINNING AT A POINT BEING LOCATED SOUTH 83°21'02" WEST 20.84 FEET ALONG THE SOUTH LINE OF SAID SOUTHEAST QUARTER AND NORTH 00°00'00" EAST 585.32 FEET FROM THE SOUTHEAST CORNER OF SAID SECTION 18; RUNNING THENCE SOUTH 84°59'39" WEST 64.65 FEET; THENCE NORTH 00°44'45" EAST 675.99 FEET; THENCE NORTH 87°32'45" EAST 64.43 FEET; THENCE SOUTH 00°44'45" WEST 673.11 FEET TO THE POINT OF BEGINNING, CONTAINING 1.00 ACRES.

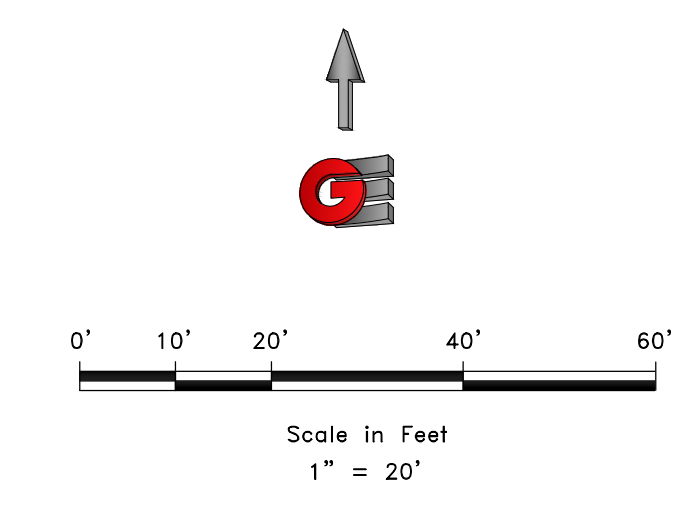

- LEGEND**
- ◆ WEBER COUNTY MONUMENT AS NOTED
  - SET 24" REBAR AND CAP MARKED GARDNER ENGINEERING
  - FOUND EASEMENT MARKER
  - SUBJECT PROPERTY BOUNDARY
  - LOT LINE
  - - - ADJACENT PARCEL
  - - - SECTION LINE
  - - - EASEMENT
  - - - EXISTING FENCE LINE

**NARRATIVE**

THE PURPOSE OF THIS SURVEY WAS TO ESTABLISH AND SET THE PROPERTY CORNERS OF THE PARCEL AS SHOWN AND DESCRIBED HEREON. THE SURVEY WAS ORDERED BY BRONSON ARCHULETA. THE BASIS OF BEARING IS THE SOUTH LINE OF THE SOUTHEAST QUARTER OF SECTION 18, TOWNSHIP 6 NORTH, RANGE 1 EAST, SALT LAKE BASE AND MERIDIAN WHICH BEARS SOUTH XX°XX'XX" WEST, WEBER COUNTY, UTAH NORTH, NAD 83 STATE PLANE GRID BEARING. THE BOUNDARY WAS DETERMINED BY WARRANTY DEED RECORDED AS ENTRY NUMBER 3082186, 3082187, AND DEEDS OF ADJOINING PROPERTY OWNERS. RECORD OF SURVEY NUMBERS 3115, 4742, 6666 ALONG WITH THE FOUND MONUMENTS AS SHOWN AND DESCRIBED HEREON.

**SURVEYOR'S CERTIFICATE**

I, KLINT H. WHITNEY, DO HEREBY CERTIFY THAT I AM A LICENSED PROFESSIONAL LAND SURVEYOR IN THE STATE OF UTAH AND THAT I HOLD CERTIFICATE NO. 8227228 IN ACCORDANCE WITH TITLE 58, CHAPTER 22, OF THE PROFESSIONAL ENGINEERS AND LAND SURVEYORS ACT; I FURTHER CERTIFY THAT BY AUTHORITY OF THE OWNERS I HAVE COMPLETED A SURVEY OF THE PROPERTY DESCRIBED ON THIS RECORD OF SURVEY PLAT IN ACCORDANCE WITH SECTION 17-23-20 AND HAVE VERIFIED ALL MEASUREMENTS; THAT THE REFERENCE MONUMENTS SHOWN ON THIS RECORD OF SURVEY PLAT ARE LOCATED AS INDICATED AND ARE SUFFICIENT TO RETRACE OR REESTABLISH THIS SURVEY; AND THAT THE INFORMATION SHOWN HEREIN IS SUFFICIENT TO ACCURATELY ESTABLISH THE LATERAL BOUNDARIES OF THE HEREIN DESCRIBED TRACT OF REAL PROPERTY.

SIGNED THIS 12TH DAY OF FEBRUARY, 2026.

RECEIVED  
APR 24 2026  
FILE # 8333

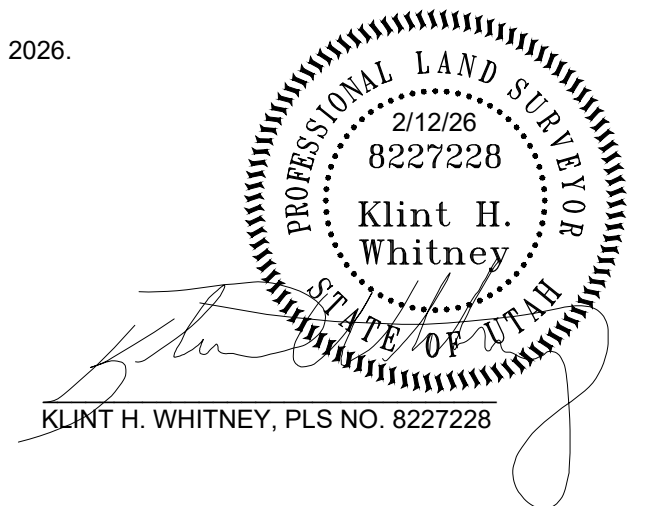

REVISIONS	DESCRIPTION
DATE	

SCALE: 1" = 20"  
DATE: 2/12/26  
DESIGN: \_\_\_\_\_  
DRAWN: KHW  
CHECKED: KHW  
DWG.: R:\2021-2026 SURVEYS\2026\BRONSON ARCHULETA SURVEY\BRONSON ARCHULETA.RDS.DWG

PROPERTY SURVEY FOR BRONSON ARCHULETA  
583 OGDEN CANYON ROAD, OGDEN, UTAH  
LOCATED IN THE SOUTHEAST QUARTER OF SECTION 18,  
TOWNSHIP 6 NORTH, RANGE 1 EAST, S.L.B. AND M.

**GARDNER ENGINEERING**  
CIVIL - LAND PLANNING  
MUNICIPAL - LAND SURVEYING  
1580 W 2100S, WEST HAVEN, UT 84401  
P 801.476.0202 F 801.476.0066

S1  
1