

# RECORD OF SURVEY

## 2828 E SHAW DR, LIBERTY, UTAH

### A PART OF THE SOUTHEAST QUARTER OF SECTION 7, TOWNSHIP 7 NORTH, RANGE 1 EAST, SALT LAKE BASE AND MERIDIAN, U.S. SURVEY

### LIBERTY, WEBER COUNTY UTAH

### NOVEMBER, 2025



VICINITY MAP  
NOT TO SCALE

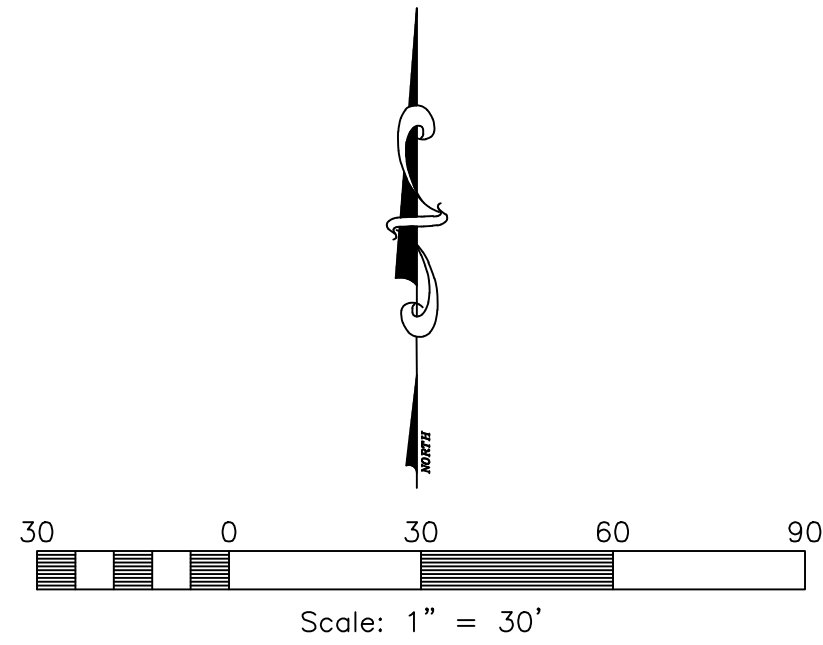

#### LEGEND

- = SECTION CORNER
- = SET 5/8" REBAR AND PLASTIC CAP STAMPED "REEVE & ASSOCIATES"
- = BOUNDARY LINE
- = ADJOINING PROPERTY
- = SECTION TIE LINE
- = FENCE LINE
- = EX-OHP
- = OVERHEAD POWER
- = RECORD INFORMATION
- = WATER METER
- = UTILITY POLE
- = EXISTING BUILDING
- = EXISTING PAVEMENT
- = EXISTING GRAVEL

#### NARRATIVE

THIS SURVEY WAS REQUESTED BY TIMOTHY CLARK FOR THE PURPOSE OF REESTABLISHING THE BOUNDARY OF THE HEREON DESCRIBED PARCEL OF LAND.

BRASS CAP MONUMENTS WERE FOUND FOR THE EAST QUARTER CORNER AND SOUTHEAST CORNER OF SECTION 7, TOWNSHIP 7 NORTH, RANGE 1 EAST, SALT LAKE BASE AND MERIDIAN, U.S. SURVEY.

A LINE BEARING NORTH 00°45'13" EAST EAST BETWEEN SAID EAST QUARTER CORNER AND SOUTHEAST CORNER OF SECTION 17 WAS USED AS THE BASIS OF BEARINGS FOR THIS SURVEY.

A SUBDIVISION PLAT FOR STARNES ESTATES - FIRST AMENDMENT PREPARED BY C.L.S. INC., DATED NOVEMBER 27, 2006, AND RECORDED NOVEMBER 27, 2006; A PLAT FOR TWO SADDLES HIGH SUBDIVISION PREPARED BY REEVE & ASSOCIATES DATED NOVEMBER 25, 2013, AND RECORDED NOVEMBER 27, 2013; AND A RECORD OF SURVEY PREPARED BY REEVE & ASSOCIATES FOR ANDREW ADAMS, DATED MAY 2, 2013, AND FILED JUNE 17, 2013 WERE USED AS REFERENCE FOR THIS SURVEY.

BOUNDARIES OF THE PARCELS WERE ESTABLISHED BY INFORMATION OF RECORD AND FOUND EVIDENCE OF OCCUPATION ON THE GROUND. THE WESTERLY BOUNDARY AND A PORTION OF THE EASTERLY BOUNDARY WERE ESTABLISHED BY PLAT, THE SOUTH LINE WAS ESTABLISHED BY THE SOUTH LINE OF THE NORTH HALF OF THE SOUTHEAST QUARTER OF SECTION 7 AS CALCULATED.

PROPERTY CORNERS ARE SET WITH A 5/8" REBAR AND PLASTIC CAP STAMPED "REEVE & ASSOCIATES". ALL FRONT LOT CORNERS WERE SET WITH A LEAD PLUG IN THE TOP BACK OF CURB AT THE EXTENSION OF THE SIDE LOT LINES.

#### BOUNDARY DESCRIPTION

PART OF SECTION 7, TOWNSHIP 7 NORTH, RANGE 1 EAST, SALT LAKE BASE AND MERIDIAN:

BEGINNING AT THE NORTHEAST CORNER OF STARNES ESTATES - FIRST AMENDMENT AS RECORDED WITH THE WEBER COUNTY RECORDER, SAID POINT BEARS SOUTH 86°07'40" WEST 1751.95 FEET (SOUTH 86°13'18" WEST 1752.50' REC.), SOUTH 14°35'42" EAST 938.40 FEET (941.32' REC.) FROM THE WEBER COUNTY SURVEYOR'S MONUMENT MARKED AS THE EAST QUARTER CORNER OF SAID SECTION 7, (SAID EAST QUARTER CORNER BEARS NORTH 00°45'13" EAST 2650.41 FEET FROM THE SOUTHEAST CORNER OF SAID SECTION 7 BRASS CAP MARKER DATED 1998); THENCE THREE (3) COURSES ALONG THE EASTERLY LINE OF SAID STARNES ESTATES - FIRST AMENDMENT AS FOLLOWS: (1) SOUTH 42°30'34" WEST 331.76 FEET TO THE CENTER LINE OF WEST DITCH OF LIBERTY IRRIGATION COMPANY; (2) SOUTH 47°51'11" WEST 185.48 FEET ALONG SAID DITCH; AND (3) SOUTH 25°44'18" WEST 68.35 FEET (64.75' REC.) ALONG AND BEYOND SAID DITCH TO THE CENTER OF A ROAD, SAID POINT ALSO BEING THE SOUTH LINE OF THE NORTH 1/2 OF SAID QUARTER SECTION; THENCE NORTH 85°58'43" EAST 410.85 FEET (NORTH 85°43' EAST 418' REC.) ALONG THE SOUTH LINE OF THE NORTH 1/2 OF SAID QUARTER SECTION; THENCE NORTH 23°01'38" WEST 263.71 FEET (NORTH 87°41' EAST 201' REC.) TO THE SOUTHWEST CORNER OF TWO SADDLES HIGH SUBDIVISION AS RECORDED WITH THE WEBER COUNTY RECORDER; THENCE THREE (3) COURSES ALONG THE WESTERLY LINE OF SAID TWO SADDLES HIGH SUBDIVISION AS FOLLOWS: (1) NORTH 25°25'55" WEST 140.00 FEET; THENCE SOUTH 85°57'18" WEST (SOUTH 85°43' WEST REC.) 62.00 FEET; THENCE NORTH 14°35'42" 22.84 FEET (NORTH 14°12' WEST REC.) TO BEGINNING.

CONTAINS: 86,216 SQUARE FEET OR 1.979 ACRES

#### SURVEYOR'S CERTIFICATE

I, **JASON FELT**, DO HEREBY CERTIFY THAT I AM A PROFESSIONAL LAND SURVEYOR IN THE STATE OF UTAH IN ACCORDANCE WITH TITLE 58, CHAPTER 22, PROFESSIONAL ENGINEERS AND PROFESSIONAL LAND SURVEYORS ACT; AND THAT I HAVE COMPLETED A SURVEY OF THE PROPERTY DESCRIBED ON THIS PLAT IN ACCORDANCE WITH SECTION 17-23-17 AND HAVE VERIFIED ALL MEASUREMENTS, AND HAVE PLACED MONUMENTS AS REPRESENTED ON THIS PLAT. I FURTHER CERTIFY THAT THIS PLAT IS A CORRECT REPRESENTATION OF THE LAND SURVEYED AND HAS BEEN PREPARED IN CONFORMITY WITH THE MINIMUM STANDARDS AND REQUIREMENTS OF THE LAW.

SIGNED THIS 24th DAY OF FEBRUARY, 2026.

9239283  
UTAH LICENSE NUMBER

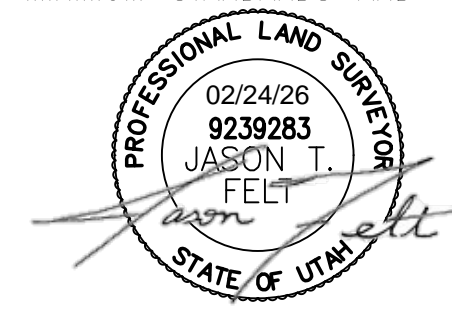

**Reeve & Associates, Inc.**  
5160 SOUTH 1500 WEST, REVERDALE, UTAH, 84403  
PHONE: (801) 621-3100 FAX: (801) 621-3666 WWW.REEVECO.COM  
LAND SURVEYING, CIVIL ENGINEERING, SURVEYING, ENGINEERING, UTILITY ENGINEERING

REVISIONS	DESCRIPTION	DATE

**RECORD OF SURVEY**  
WEBER COUNTY, UTAH

**TIMOTHY CLARK PROPERTY**  
2828 E. SHAW DR., LIBERTY, UTAH

**Project Info.**

Surveyor:	J. FELT
Designer:	J. FELT
Begin Date:	11/5/2025
Name:	CLARK
Scale:	1"=30'
Checked:	
Number:	8633-01