

Northeast Corner Section 13,
Township 6 North, Range 3 West,
Salt Lake Base and Meridian.
Fnd. Weber County brass cap
monument as per tie sh'ts.

East Quarter Corner Section 13,
Township 6 North, Range 3 West,
Salt Lake Base and Meridian.
Fnd. brass cap monument as per
Weber County Surveyor's tie sh't.

Southwest Corner Section 13,
Township 6 North, Range 3 West,
Salt Lake Base and Meridian.
Fnd. Weber County brass cap well
monument as per tie sh'ts.

South Quarter Corner Section 13,
Township 6 North, Range 3 West,
Salt Lake Base and Meridian.
Fnd. Weber County brass cap
monument as per tie sh'ts.

Southeast Corner Section 13,
Township 6 North, Range 3 West,
Salt Lake Base and Meridian.
Not fnd. location determined from
Weber County "Meander Corners"
Fnd. as per County Tie Sh'ts.

Found Weber County
brass cap "Meander Corner"
as per County Tie Sh'ts.

554°19'54"W 3238.05' Meas.

TAX PARCEL 10-035-0004
HOWARD
ENTRY #2883088

TAX PARCEL 10-035-0024
CARLIN
ENTRY #2800307

SUBJECT PARCEL
Contains 1.99 acres
±86,621 sq. ft.

TAX PARCEL 10-035-0007
PCC LAND, LLC
ENTRY #3208857

South Quarter Corner Section 13,
Township 6 North, Range 3 West,
Salt Lake Base and Meridian.
Fnd. Weber County brass cap
monument as per tie sh'ts.

Southeast Corner Section 13,
Township 6 North, Range 3 West,
Salt Lake Base and Meridian.
Location determined by distance
distance intersect from
Weber County Witness Monuments
See Record of Survey #7384

Found Weber County
brass cap "Meander Corner"
as per County Tie Sh'ts.

NARRATIVE:

Boundary Consultants was retained by the Robert Christensen to survey Weber County Tax Parcel 10-035-0029 and set the corners thereof.

This survey was carried out using a Trimble S6 Total Station, with ground distances being determined by GEOID Model CONUS 12B @ height 4392.00 feet and no calibration. Basis of Bearing for this survey is NORTH as determined by the Utah TURN VRS System, or North 00°21'10" East 2664.58 feet, measured, between the Weber County Surveyor's brass cap monuments marking the East Quarter Corner and the Northeast Corner of Section 13, Township 6 North, Range 2 West, Salt Lake Base and Meridian.

The Basis of Bearing used in this survey not the same used in the vesting deed. There is a counter clockwise rotation of 00°24'51" to match the record to this survey. Each course depicted on this survey references the record bearing and distances.

WARRANTY DEED, ENTRY #3375931:

A parcel of land being part of an entire tract of land described in that certain Quit Claim Deed recorded July 02, 2003 as Entry No. 1953333 in the Office of the Weber County Recorder. Said parcel is located in the Southwest Quarter of Section 13, Township 6 North, Range 3 West, Salt Lake Base and Meridian and the Southwest Quarter of Section 18, Township 6 North, Range 2 West, Salt Lake Base and Meridian and is described as follows:

Beginning at a point on the westerly right-of-way line of 5900 West Street, which is 1318.43 feet South 00°11'57" West along the section line and 154.67 feet EAST from the East Quarter Corner of said Section 13; Thence North 89°20'03" West (R=WEST) 439.57 feet to and along an existing iron fence; Thence North 89°04'05" West (R=WEST) 324.64 feet along said existing iron fence and extension thereof; Thence North 56°51'31" East (R=Northeasterly) 210.35 feet; Thence South 89°48'03" East (R=EAST) 391.96 feet; Thence North 00°11'57" East (R=NORTH) 26.29 feet; Thence South 89°48'03" East 196.23 feet (R=EAST 180 feet) to said westerly right-of-way line of 5900 West Street; Thence South 00°06'21" West 149.63 feet (R=SOUTH 150 feet) along said westerly right-of-way line to the point of beginning.

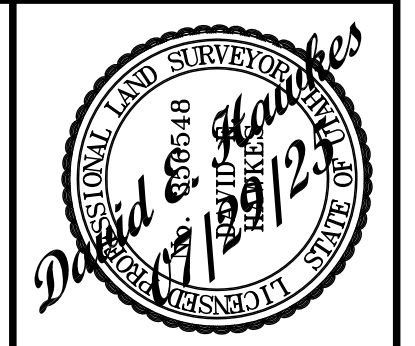
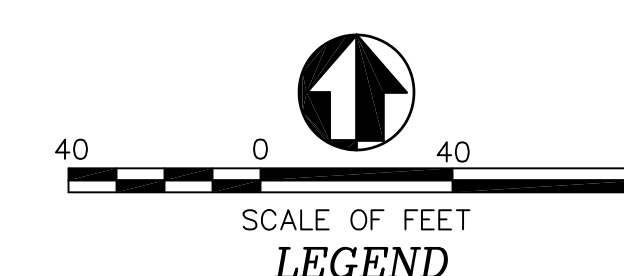
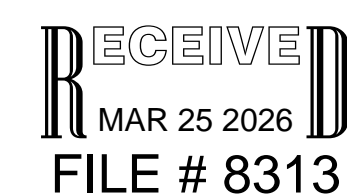

DATE: 07-29-25
SCALE: 1"=40'
PROJECT NUMBER: 2509001

RECORD OF SURVEY OF WEBER COUNTY
TAX PARCEL 10-035-0029
LYING AND SITUATE IN THE SOUTHEAST QUARTER OF SECTION 13,
TOWNSHIP 6 NORTH, RANGE 3 WEST, SALT LAKE BASE AND MERIDIAN
AND THE SOUTHWEST QUARTER OF SECTION 18, TOWNSHIP 6 NORTH,
RANGE 2 WEST, SALT LAKE BASE AND MERIDIAN

Boundary Consultants
Professional Land Surveyors
5554 West 2425 North, Hooper, Utah
(801) 792-1569
dave@boundaryconsultants.biz

DESIGNED	DEH	DEH	DEH
DRAWN			
CHECKED			
SHEET	1		
OF	1		