

RECORD BOUNDARY DESCRIPTION

PART OF THE WEST 1/2 OF THE SOUTHEAST QUARTER OF SECTION 32 AND PART OF AN UN-NUMBERED LOT IN PLAIN CITY SURVEY, TOWNSHIP 7 NORTH, RANGE 2 WEST, SALT LAKE BASE AND MERIDIAN, U.S. SURVEY: BEGINNING AT A POINT WHICH IS 4 RODS SOUTH AND 185.45 FEET WEST FROM THE SOUTHWEST CORNER OF BLOCK 3, PLAT A, PLAIN CITY SURVEY, AND RUNNING THENCE SOUTH 114.5 FEET, THENCE EAST 9.0 FEET, THENCE SOUTH 45D WEST 134.35 FEET, THENCE WEST 5 FEET, THENCE NORTH 209.5 FEET, THENCE EAST 100 FEET TO THE POINT OF BEGINNING. ALSO: PART OF THE WEST 1/2 OF THE SOUTHEAST QUARTER OF SECTION 32 AND PART OF AN UN-NUMBERED LOT IN PLAIN CITY SURVEY, TOWNSHIP 7 NORTH, RANGE 2 WEST, SALT LAKE BASE & MERIDIAN, U.S. SURVEY: BEGINNING AT A POINT WHICH IS 280.5 FEET SOUTH AND 176.45 FEET WEST FROM THE SOUTHWEST CORNER OF BLOCK 3, PLAT A, PLAIN CITY SURVEY, AND RUNNING THENCE WEST 109.00 FEET, THENCE NORTH 5 FEET, THENCE EAST 5 FEET, THENCE NORTH 45D EAST 134.35 FEET, THENCE SOUTH 100.00 FEET, MORE OR LESS, TO THE POINT OF BEGINNING.

AS SURVEYED BOUNDARY DESCRIPTION

A PART OF THE SOUTHEAST QUARTER OF SECTION 32, TOWNSHIP 7 NORTH, RANGE 2 WEST, OF THE SALT LAKE BASE AND MERIDIAN, BEGINNING AT A POINT ON THE SOUTH RIGHT-OF-WAY LINE OF 2200 WEST STREET BEGIN LOCATED SOUTH 00°41'59" WEST 3342.06 FEET ALONG THE EAST LINE OF SAID SECTION 32 AND NORTH 90°00'00" WEST 1435.21 FEET FROM THE NORTHEAST CORNER OF SAID SECTION 32; RUNNING THENCE SOUTH 00°56'24" WEST 113.94 FEET; THENCE SOUTH 88°40'55" EAST 9.00 FEET; THENCE SOUTH 00°56'24" WEST 100.56 FEET; THENCE NORTH 88°40'59" WEST 113.95 FEET; THENCE NORTH 00°56'24" EAST 214.50 FEET TO SAID SOUTH RIGHT-OF-WAY LINE; THENCE ALONG SAID SOUTH RIGHT-OF-WAY LINE SOUTH 88°40'55" EAST 104.95 FEET TO THE POINT OF BEGINNING. CONTAINING 23,417 SQUARE FEET.

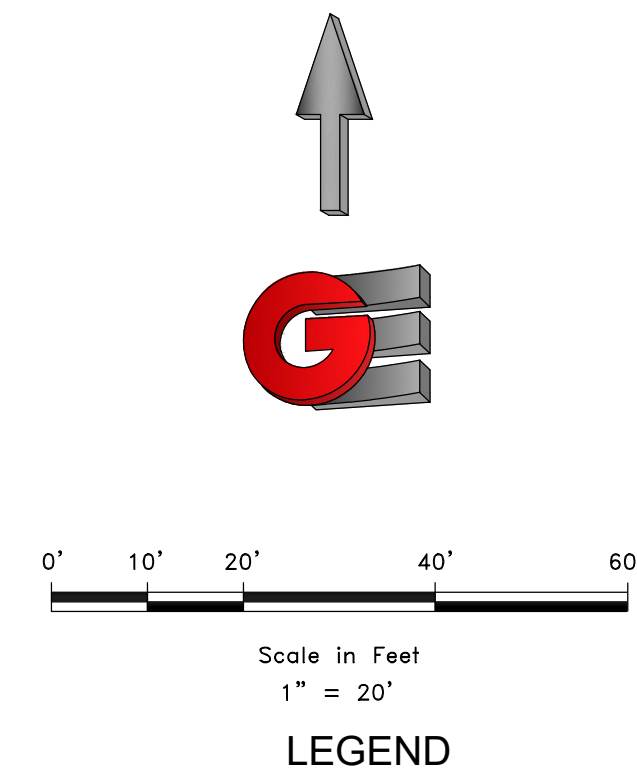

RECEIVED
AUG 13 2025
FILE # 8126

NARRATIVE

THE PURPOSE OF THIS SURVEY WAS TO ESTABLISH AND SET THE PROPERTY CORNERS OF THE PARCEL AS SHOWN AND DESCRIBED HEREON. THE SURVEY WAS ORDERED BY DARLENE FILBAN. THE BASIS OF BEARING IS THE EAST LINE OF SECTION 32, TOWNSHIP 7 NORTH, RANGE 2 WEST, OF THE SALT LAKE BASE AND MERIDIAN WHICH BEARS SOUTH 00°41'59" WEST, WEBER COUNTY, UTAH NORTH, NAD 83 STATE PLANE GRID BEARING. THE BOUNDARY WAS DETERMINED BY QUIT CLAIM DEED RECORDED AS ENTRY NUMBER 2520213, AND DEEDS OF ADJOINING PROPERTY OWNERS. THE DEDICATED PLATS OF PLAIN CITY PLAT WAS ALSO USED TO DETERMINE BOUNDARY LOCATION ALONG WITH THE FOUND MONUMENTS AS SHOWN AND DESCRIBED HEREON. OCCUPATION WAS MEASURED OVER MULTIPLE BLOCKS TO DETERMINE ROADWAY CENTERLINES. SAID CENTERLINES WERE THEN OFFSET BY DEEDED DISTANCES TO ELIMINATE THE ERRORS IN THE MEETS AND BOUNDS DESCRIPTIONS CONTAINING IN THE DEEDS.

SURVEYOR'S CERTIFICATE

I, KLINT H. WHITNEY, DO HEREBY CERTIFY THAT I AM A LICENSED PROFESSIONAL LAND SURVEYOR IN THE STATE OF UTAH AND THAT I HOLD CERTIFICATE NO. 8227228 IN ACCORDANCE WITH TITLE 58, CHAPTER 22, OF THE PROFESSIONAL ENGINEERS AND LAND SURVEYORS ACT; I FURTHER CERTIFY THAT BY AUTHORITY OF THE OWNERS I HAVE COMPLETED A SURVEY OF THE PROPERTY DESCRIBED ON THIS RECORD OF SURVEY PLAT IN ACCORDANCE WITH SECTION 17-23-20 AND HAVE VERIFIED ALL MEASUREMENTS; THAT THE REFERENCE MONUMENTS SHOWN ON THIS RECORD OF SURVEY PLAT ARE LOCATED AS INDICATED AND ARE SUFFICIENT TO RETRACE OR REESTABLISH THIS SURVEY; AND THAT THE INFORMATION SHOWN HEREIN IS SUFFICIENT TO ACCURATELY ESTABLISH THE LATERAL BOUNDARIES OF THE HEREIN DESCRIBED TRACT OF REAL PROPERTY.

SIGNED THIS 17TH DAY OF MAY, 2023.

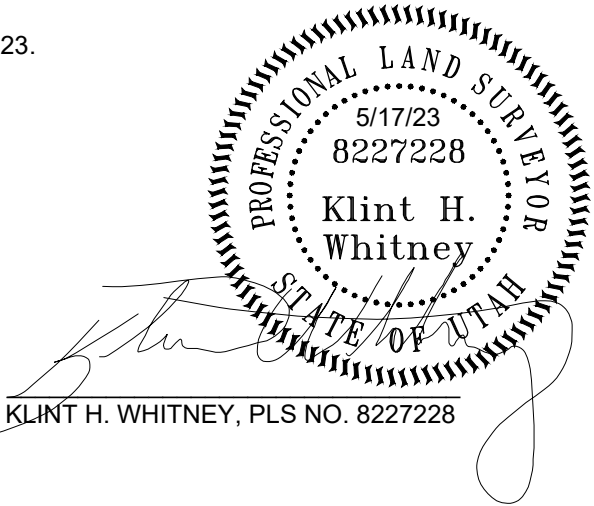

SCALE: 1/20\"/>	
DATE: 5/17/23	
DESIGN: KHW	
DRAWN: KHW	
CHECKED: KHW	
DWG.: E:\2001-1\MSGSURVEY\2046-DARLENE FILBAN\SURVEY\DWG\2046-DARLENE FILBAN.DWG	
REVISIONS	
DATE	DESCRIPTION
PROPERTY SURVEY FOR DARLENE FILBAN	
4529 WEST 2200 NORTH, PLAIN CITY, UTAH	
LOCATED IN THE SOUTHWEST QUARTER OF SECTION 32,	
TOWNSHIP 7 NORTH, RANGE 2 WEST, S.L.B. AND M.	
GARDNER ENGINEERING CIVIL - LAND PLANNING MUNICIPAL - LAND SURVEYING 1880 W 2100S, WEST HAVEN, UT 84403 P 801.476.0202 F 801.476.0066	
S1	
1	